

# *Our Children's Future is in Your Hands*

Olean City  
School District's  
**Capital Project**  
brings abundant  
opportunity at little  
cost to you.



## **Yearly Tax Impact**

*for average Olean City taxpayer*

	<b>Prop. #1</b>		<b>Prop. #1 &amp; #2</b>	
	<i>Per Year</i>	<i>Per Month</i>	<i>Per Year</i>	<i>Per Month</i>
Senior STAR	\$ 4	\$0.33	\$ 4	\$0.33
Basic STAR	\$17	\$1.42	\$20	\$1.67
No STAR	\$31	\$2.58	\$37	\$3.08



# **Olean City School District**

# Olean City School District

Proposition #1 - \$51,929,000 - Additions, Renovations, Health & Safety Compliance, and Technology Upgrades

Proposition #2 - \$3,605,000 - Turf Field/Athletic Complex at the Middle School on Wayne Street

## TOP 4 Educational Advantages

for Creating a 21<sup>st</sup> Century learning environment for our community

### 1 Improved Classrooms

- Expanded instructional space in classrooms
- Improved climate control and ventilation
- New furniture and fixtures designed for teaching in small groups

### 2 Increased efficiencies

- Consolidation of resources
- Improved teacher collaboration and team teaching
- Standardize special education programs across the District
- Better scheduling of art, music, library, technology
- Less instructional time lost from teachers traveling between schools

### 3 Enhanced instruction through technology improvements

- More “Smartboards” and ceiling mounted projectors
- Electrical updates to handle increased use of technology
- Wireless network across the District insuring anytime anywhere learning
- Increased number of student computer work stations and mobile labs
- Upgrading to three state-of-the-art Library Media Centers in elementary schools

### 4 Increased safety for our students

- Rearranging the entry to buildings to allow more direct oversight to entrances
- Bathrooms in all Pre-K-2 classrooms
- Full-time counselor in every school
- Better traffic flow and increased parking at all elementary schools

“We have worked hard to find a solution that minimizes the financial impact to the local taxpayer. We believe this project is educationally sound, fiscally responsible, and addresses the 21<sup>st</sup> century learning needs of our students. We encourage you to become informed and exercise your right to vote.”

- Olean Board of Education

## Estimated Project Costs

	Prop. #1	Prop. #2	Total
Building Additions (BV, EV, WW)	\$11,286,413		\$11,286,413
Building Renovations (BV, EV, HS, WW)	\$26,378,797		\$26,378,797
Health & Safety Items	\$10,076,830		\$10,076,830
Athletic Complex		\$ 3,605,000	\$ 3,605,000
Technology Updates (BV, EV, HS, WW)	\$ 4,186,960		\$ 4,186,960
<b>TOTAL</b>	<b>\$51,929,000</b>	<b>\$ 3,605,000</b>	<b>\$55,534,000</b>



## Proposition 1 - \$51,929,000

Local Share  
7.54%

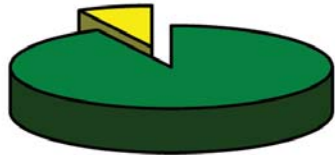

State Building  
Aid & Other  
Sources  
92.46%

## Proposition 1 & 2 Combined \$55,534,000

Local Share Prop  
1 & 2  
8.08%

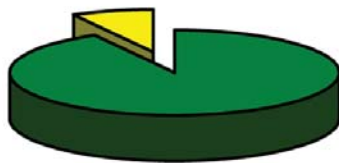

State Building  
Aid & Other  
Sources  
91.92%

## Average Annual Cost to the Taxpayer

		Proposed Capital Project Proposition 1 (\$51,929,000 & Proposition 2 (\$3,605,000)					
		Senior/STAR \$4,850 Assessed Value Exemption Income Restrictions *		With STAR \$2,570 Assessed Value Exemption Primary Residence		No STAR Non-Primary Residence	
	Assessed Value	Prop 1 Annual	Prop 1 & 2 Annual	Prop 1 Annual	Prop 1 & 2 Annual	Prop 1 Annual	Prop 1 & 2 Annual
<b>City of Olean</b>							
	\$4,500	---0---	---0---	\$11	\$13	\$25	\$31
Average	\$5,500	\$4	\$4	\$17	\$20	\$31	\$37
	\$6,458	\$9	\$11	\$22	\$26	\$37	\$44
	\$7,500	\$15	\$18	\$28	\$34	\$42	\$51
	\$8,500	\$21	\$25	\$34	\$40	\$48	\$58
	\$9,500	\$26	\$32	\$39	\$47	\$54	\$65
<b>Town of Olean</b>							
	\$50,000	---0---	---0---	\$12	\$15	\$27	\$32
Average	\$60,000	\$5	\$6	\$18	\$21	\$32	\$39
	\$68,621	\$9	\$11	\$22	\$27	\$37	\$44
	\$80,000	\$15	\$18	\$28	\$34	\$43	\$51
	\$90,000	\$21	\$25	\$34	\$40	\$48	\$58
	\$100,000	\$26	\$31	\$39	\$47	\$53	\$64
<b>Town of Portville</b>							
	\$60,000	\$1	\$2	\$14	\$16	\$27	\$33
Average	\$70,000	\$6	\$7	\$18	\$22	\$32	\$38
	\$80,731	\$11	\$13	\$23	\$28	\$37	\$44
	\$90,000	\$15	\$18	\$27	\$33	\$41	\$49
	\$100,000	\$20	\$24	\$32	\$38	\$45	\$54
	\$110,000	\$24	\$29	\$36	\$44	\$50	\$60

\* Check with local assessor concerning income restrictions on Senior STAR





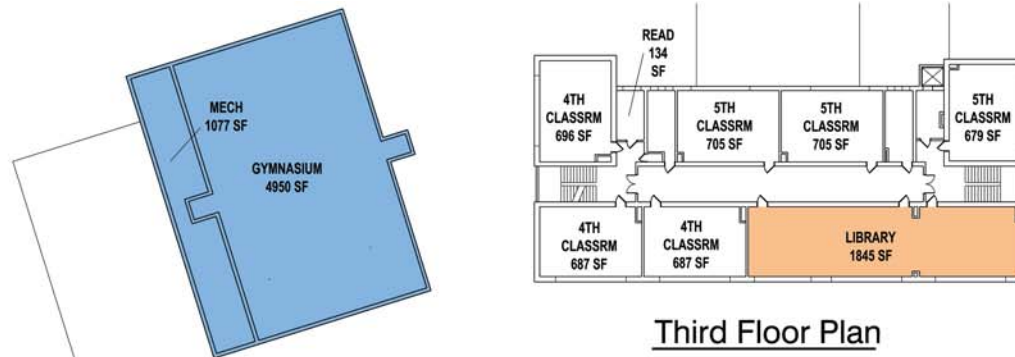

Third Floor Plan

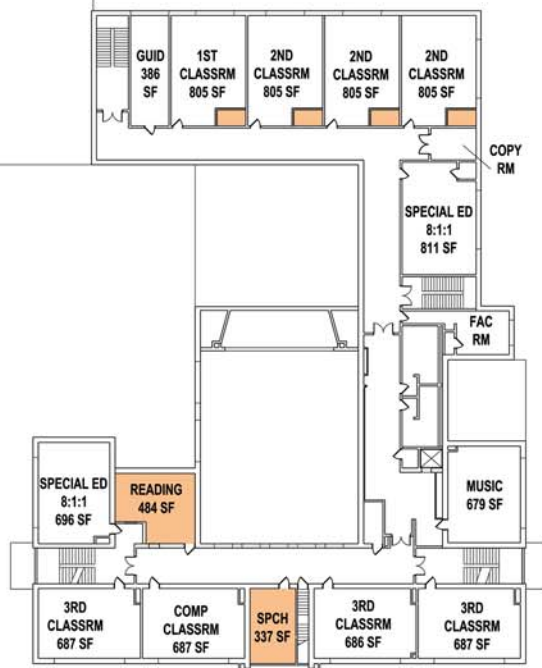

Second Floor Plan

#### Boardmanville Elementary Highlights

- Add new gymnasium
- Add 4 new classrooms
- Relocate Main Office and Health Office to improve building security
- Expand Library
- Replace HVAC system
- Upgrade plumbing and electrical systems
- Replace roof on 2-Story classroom wing
- Add emergency generator
- Expand parking lot to provide parent drop off and additional parking
- Provide additional building security and access control

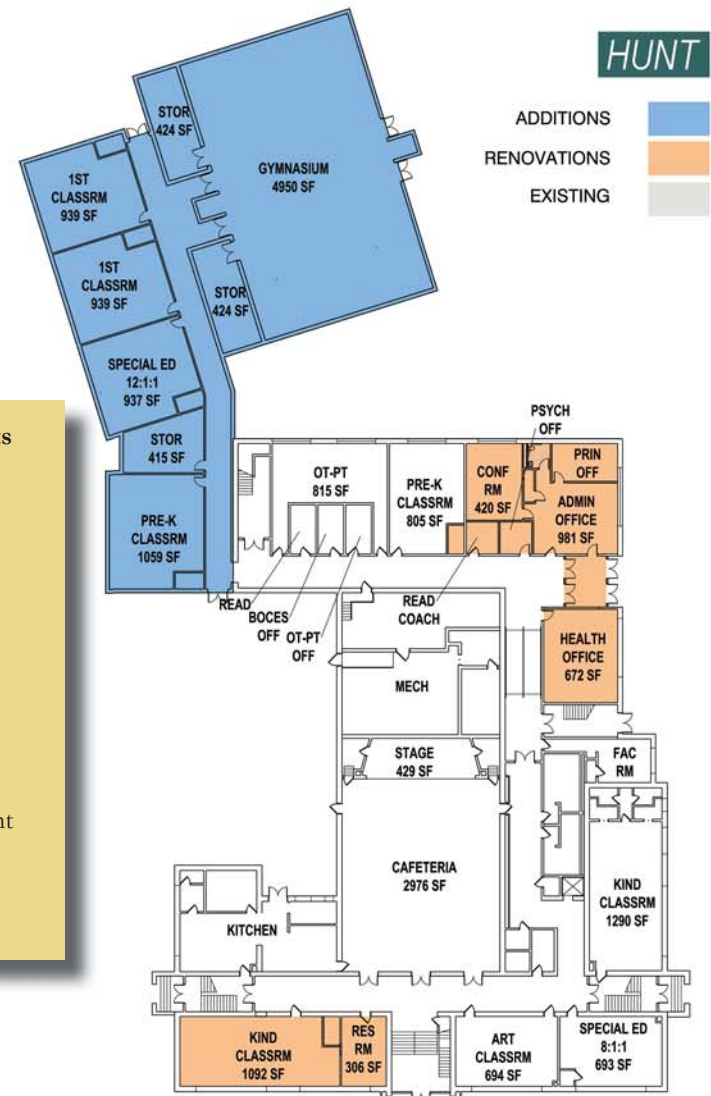

First Floor Plan

HUNT

ADDITIONS  
RENOVATIONS  
EXISTING

# Boardmanville Elementary School

## Olean City School District

Hunt Engineers, Architects & Land Surveyors, P.C.



- Add 10 new classrooms
- Relocate Main Office to improve building security
- Add parent drop off loop and handicapped ramp
- Add additional parking
- Replace boilers
- Provide additional building security and access control
- New windows
- Expand Library and Cafetorium
- Replace Flooring
- Add stage to cafetorium
- Install emergency generator
- Add wall padding in gym
- Replace metal fascia and exterior doors

ADDITIONS  
RENOVATIONS  
EXISTING

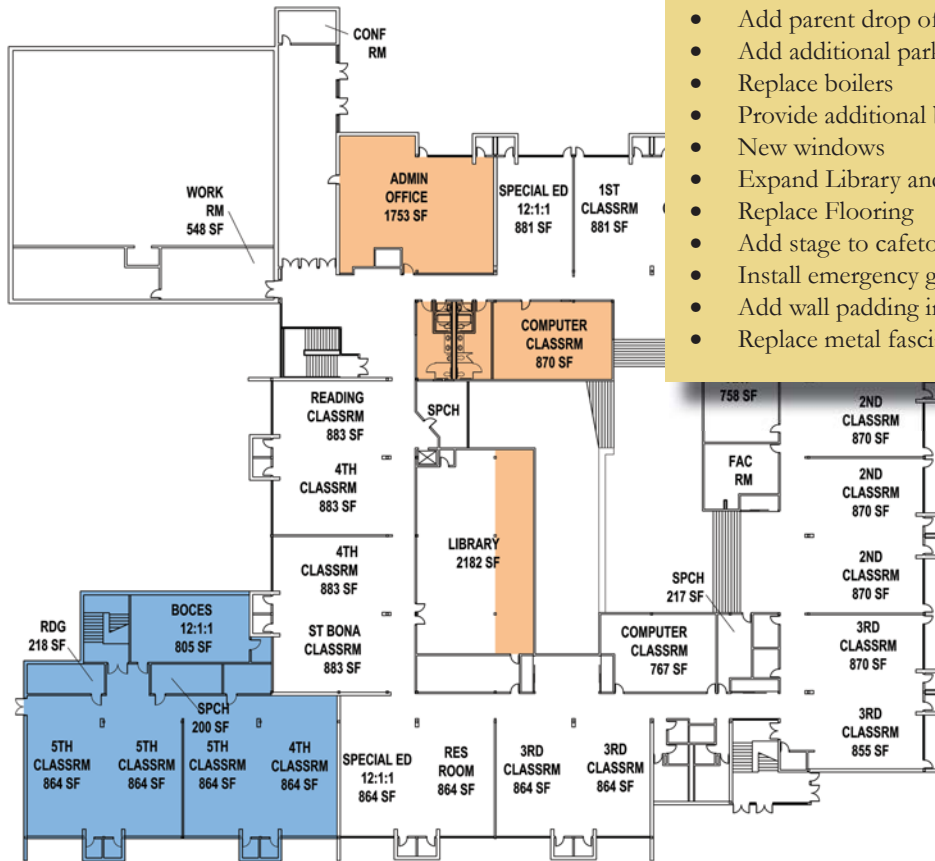

handicapped ramp

security and access control

entrance doors

OT-PT  
345 SF

COMP  
CLASSRM  
187 SF

MECHANICAL

KITCHEN  
1014 SF

MUSIC  
CLASSRM  
791 SF

CAFETERIA  
3734 SF

SPECIAL ED  
12:1:1  
828 SF

K  
CLASSRM  
1072 SF

K  
CLASSRM  
1072 SF

K  
CLASSRM  
1072 SF

K  
CLASSRM  
1072 SF

PRE-K  
CLASSRM  
1072 SF

PRE-K  
CLASSRM  
1072 SF

PRE-K  
CLASSRM  
1072 SF

PRE-K  
CLASSRM  
1072 SF

MECH

ADDITIONS

RENOVATIONS

EXISTING

### First Floor Plan

**Eastview Elementary School**  
**Olean City School District**

**Hunt Engineers, Architects & Land Surveyors, P.C.**



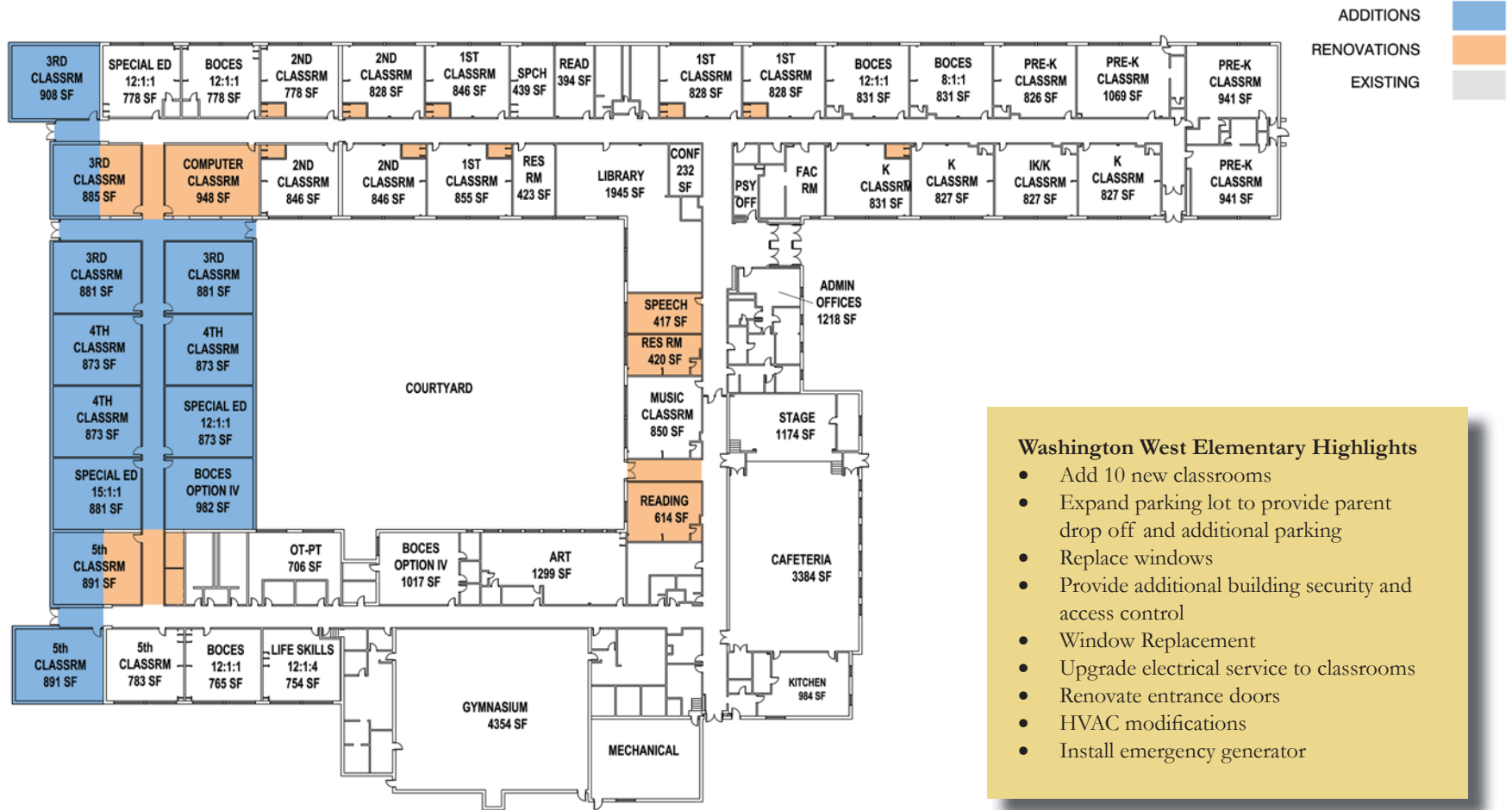

- Washington West Elementary Highlights**
- Add 10 new classrooms
  - Expand parking lot to provide parent drop off and additional parking
  - Replace windows
  - Provide additional building security and access control
  - Window Replacement
  - Upgrade electrical service to classrooms
  - Renovate entrance doors
  - HVAC modifications
  - Install emergency generator

First Floor Plan

# Washington West Elementary School

## Olean City School District

Hunt Engineers, Architects & Land Surveyors, P.C.





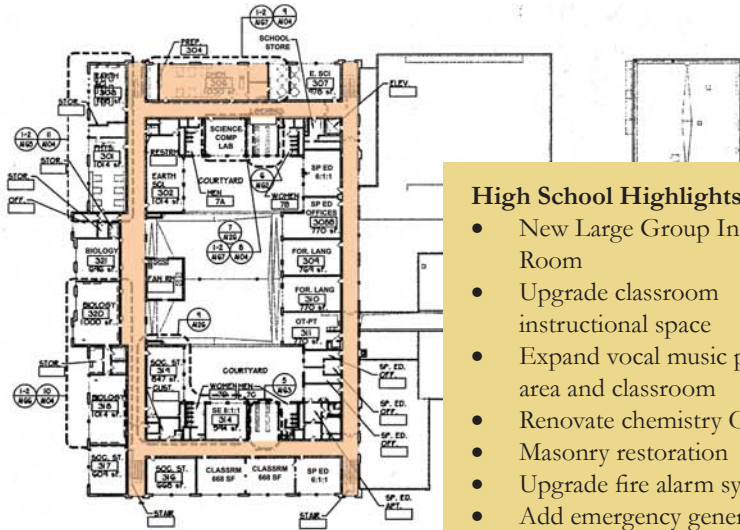

Third Floor Plan

### High School Highlights

- New Large Group Instruction Room
- Upgrade classroom instructional space
- Expand vocal music practice area and classroom
- Renovate chemistry Classroom
- Masonry restoration
- Upgrade fire alarm system
- Add emergency generator
- Replace HVAC system
- Provide additional building security and access control
- Upgrade corridors and lighting

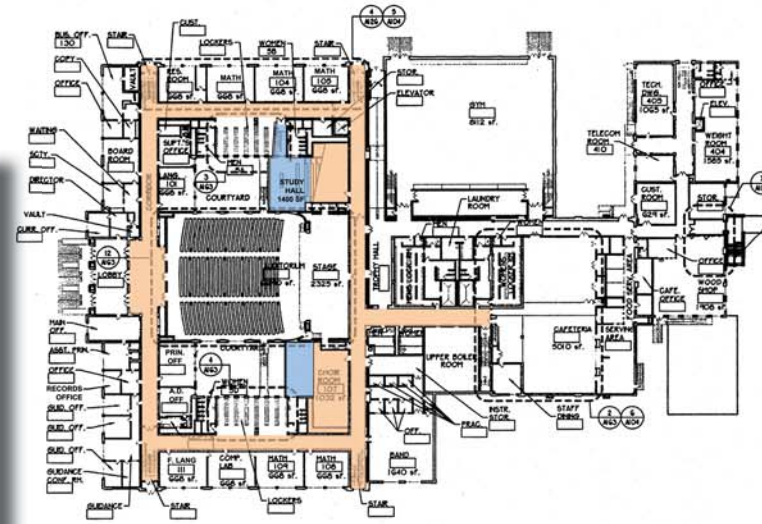

First Floor Plan

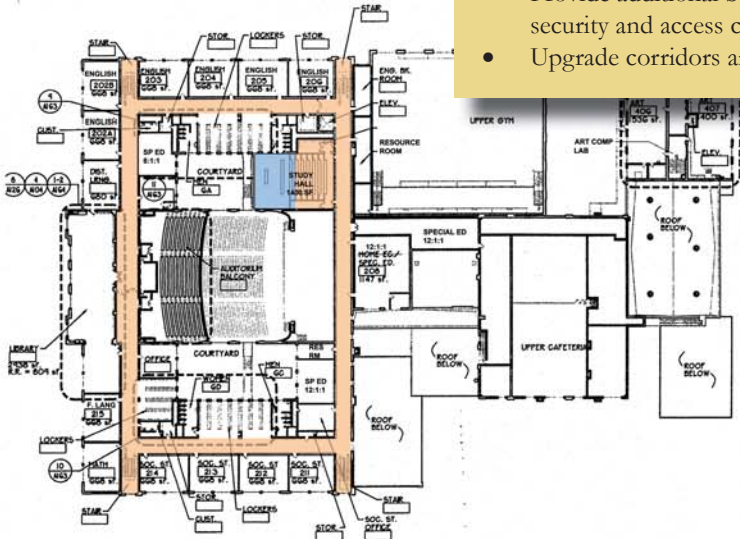

Second Floor Plan

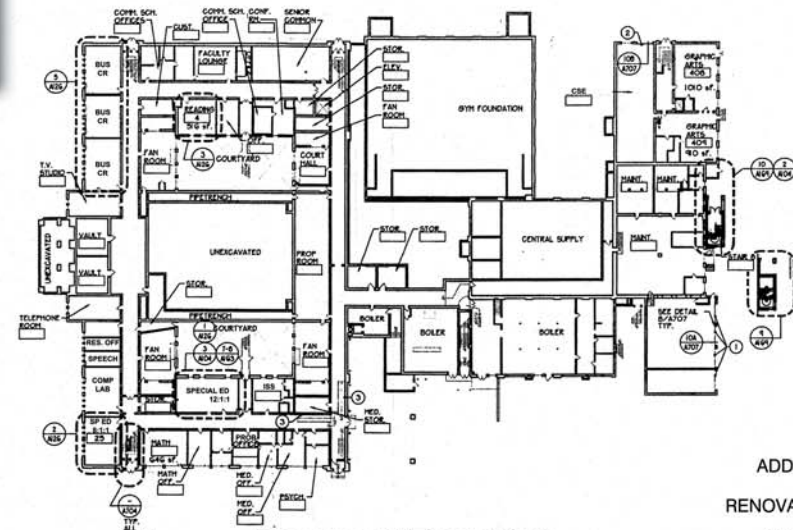

Basement Floor Plan

ADDITIONS	<span style="display:inline-block; width:15px; height:15px; background-color:blue;"></span>
RENOVATIONS	<span style="display:inline-block; width:15px; height:15px; background-color:orange;"></span>
EXISTING	<span style="display:inline-block; width:15px; height:15px; background-color:grey;"></span>

# High School

# Olean City School District

Hunt Engineers, Architects & Land Surveyors, P.C.



Proposition #2 -  
Turf Field/Athletic  
Complex located at  
the Middle School on  
Wayne Street



- HIGH JUMP
- EXISTING PARKING
- ARTIFICIAL TURF 225' X 360'  
SOCCER FIELD
- NEW FIELD LIGHTING
- EXISTING TRACK
- NEW BLEACHERS
- EXISTING PATH RELOCATED  
& EXPANDED TO ACCESS NEW  
BLEACHERS
- DISCUS
- LONG JUMP/TRIPLE JUMP

SHOT  
PUT

NEW  
BLEACHERS

NEW FIELD  
LIGHTING

EXISTING  
BLEACHERS

NEW  
BLEACHERS

POLE  
VAULT





# Concerns about our children and our community are valid

## Let us try to answer your questions . . .

### Q. How will this project be paid for?

- A. It will be bonded over fifteen (15) years with state aid and other sources covering 92%. That means for every dollar (\$1) the project costs, it will cost the local taxpayers 8 cents.

### Q. Can one proposition pass without the other?

- A. Proposition #1 (\$51,929,000 capital project) can pass on its own. However, Proposition #2 (\$3,605,000 OMS turf field/athletic improvements at the Middle School) will depend on the passage of Proposition #1, because the state aid for this project can only be generated based on voter approval of the first proposition.

### Q. What does the “Super Majority” mean?

- A. Based on laws concerning city school districts, this capital project requires a “Super Majority” which means that 60% of votes cast must approve the project — every vote is important.

### Q. Isn't state aid just my tax dollars?

- A. Yes it is! The New York State Legislature provides school districts the opportunity to access state funds to maintain, improve and expand facilities. If Olean does not take advantage of this money other communities will — as evidenced by current or planned projects in Salamanca, Allegany-Limestone, Fillmore, Franklinville, Friendship, Pioneer, Randolph and Scio, to name but a few. Why shouldn't Olean take advantage of this opportunity?

### Q. Will Ivers J. Norton (IJN) Elementary School be closing?

- A. Yes, the district had planned to close IJN and use the operational and personnel savings to decrease the local tax share on the proposed renovations and additions. However, the state has offered additional aid on the overall project (excess of \$5,000,000) with the stipulation that IJN close. That closing is projected for fall 2012.

### Q. What is EXCEL Aid?

- A. Expanding our Children's Education and Learning (EXCEL) Aid is money the state legislature has set aside for every school district to improve facilities. Olean has been allocated an additional \$1.87 million, but can only access it through a voter-approved capital project. This money will be used to reduce the local share for the project.

### Q. What is the timetable for the project?

- A. Once voter approval is received, final drawings will be developed and submitted to the NYS Education Department in October 2008. We would anticipate starting Phase I construction in summer 2009, with all construction completed by December 2012.

### Q. Did the Board consider building a new, stand-alone elementary school?

- A. Yes, the Board did explore this option, but found that the state would only provide 38% aid. A new school would cost approximately \$23,400,000, with \$14,500,000 left for local taxpayers. The Board of Education did not feel comfortable endorsing such an expensive option.

### Q. Why is Boardmanville going to be smaller than East View and Washington West?

- A. This decision is based on the financial cost of expanding Boardmanville and the lack of aid to support more building. The amount of State aid that can be generated is based on the square footage and instructional space of the existing building. Since Boardmanville is quite a bit smaller than Washington West and East View, it is eligible for much less aid. This project balances our desire to add space to the building with the realities of what we can afford.

### Q. Will the present “neighborhoods” be adjusted as a result of this project?

- A. Yes, we will have to redefine the boundaries for three elementary schools based on the projected population within the city. East View and Washington West will be designed to accommodate 425-450 students, while Boardmanville will have 325-340 students.

### Q. Will additional busing for students be available?

- A. Yes, adjustments will be needed as we transition to three elementary schools in 2012. Currently, the District provides busing for K-5 students one mile or more from their neighborhood school. Although additional busing will be needed, economies of scale will be created by standardizing special education classrooms in the District and eliminating the need for buses to double trip.

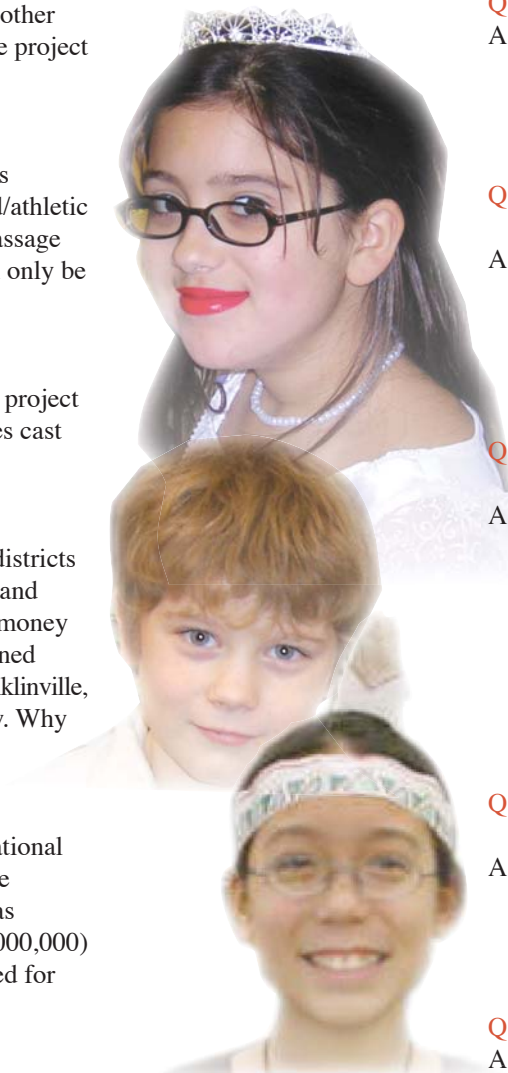

## More answers to your questions . . .

**Q. My children are grown and no longer attend Olean schools. Why should I vote for this capital project?**

A. Providing for the educational needs of our children is a “community responsibility.” Investing in our educational system will bring benefits to the Olean community and improve the quality of life for our citizens. We want to continue to give our students the best educational opportunities by providing an up-to-date learning environment that our students and community can be proud of, while at the same time, foster growth within our community as a result of our strong educational system. We firmly believe that the educational advantages outlined on page 2 make it a worthy investment for our community to make.

**Q. What does 92% state aid mean?**

A. If you wanted to remodel your kitchen at a cost of \$10,000 and someone (state) was willing to pay 92% of the cost, would you say “yes?” In the end, the \$10,000 worth of improvements would cost you \$800 spread out over 15 years. This is how state aid for our capital project will work for Olean City School District taxpayers.

**Q. Why is an artificial turf field proposed at the middle school?**

A. Having a school-owned facility will provide many advantages for the district by allowing:

- Teams to practice and play multiple games without worry of overuse, no matter the weather conditions
- Use by middle and high school physical education classes
- Increased community use for youth football, soccer and partnership with Olean Parks and Recreation Department
- Reduction of annual maintenance costs
- 92% of the cost to be paid by state funding and other sources

**Q. What about additional locker rooms, bathrooms, press box, and concession space at the middle school site?**

A. The state will not provide aid for these items. The district plans to do this work over the next few years using our own maintenance staff, as time and resources permit.

**Q. Will the state provide aid to make improvements to Bradner Stadium?**

A. No, the NYS Education Department will not provide financial aid to renovate Bradner Stadium if the city turns it over to the school district. State officials will give us additional aid at the middle school site because the athletic facility would be on a school site and available for use by middle and high school physical education classes. The Bradner site is not located adjacent to a school and could only be used for interscholastic sports which does not generate state aid, and therefore would not generate state aid. The Board of Education felt obligated to offer the community the chance to vote on whether they wanted to take advantage of the State’s offer to aid a turf field and athletic complex on Wayne Street.

**Q. Why has the district decided to build a “new athletic complex” at the middle school?**

A. The Board felt they needed to offer the community the chance to vote on this option. It is not every day that you find a sponsor willing to pay 92% of the cost to build a state-of-the-art athletic facility. If Proposition #2 is passed by 60% or more of the voters, the community will get a \$3,605,000 facility for \$50,000 a year over the fifteen (15) year bond. Lighting, additional bleachers, and a multi-sport scoreboard will be part of the project.

**Q. What are some additional benefits of this athletic facility?**

A. The district will be able to provide better safeguards and controls for our students since the facility will be located on school property and subject to school rules. We also hope the adjacent parking will make it easier for community members to attend our events and that lighting will increase the hours that we, or others in our community, can use the field. And finally, our community will have a facility that not only provides for our students but will also be a venue that local colleges, Section VI and State officials will want to use, thereby generating economic benefits to our community.

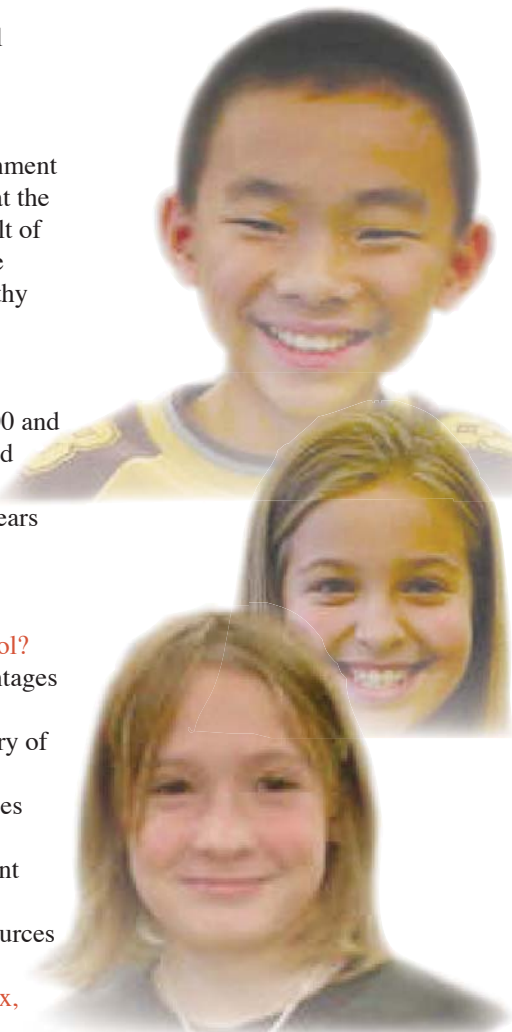

## What if the “Capital Project Proposition #1” is NOT approved?

- #1 The District cannot access the \$1.87 million in EXCEL aid. There is no guarantee that this money will remain available in the future.
- #2 We will not be able to take advantage of the additional \$5,000,000 in aid that the New York State is willing to give us with this project.
- #3 Repairs, renovations, and improvements still need to be done but the local taxpayers will have to pick up 100% cost with no state aid
- #4 IJN is in need of millions of dollars worth of “work” that will have to be addressed. This may be an expense the community cannot afford.
- #5 The large list of “educational advantages” will be out of the question without the capital project.
- #6 Energy savings and increased efficiencies will not be realized.
- #7 Our facilities will remain out-of-date and in many areas also out-of-compliance with state education regulations.
- #8 It will become increasingly more difficult to compete for new families entering our region with neighboring districts that have continually upgraded their facilities.
- #9 We will not be able to provide our students the facilities and opportunities that they will need and deserve in order to compete as 21<sup>st</sup> century learners.
- #10 The work we are proposing needs to be done now. Rising costs will continue to reduce what we can do with our money.

*More Questions?*  
*Be sure to attend the*  
**PUBLIC**  
**HEARINGS**  
**November 28**  
**&**  
**December 6**  
**7 p.m.**  
**at the Middle School**  
**LGI (second floor)**

# Voter Information

### **VOTER QUALIFICATIONS:**

- At least 18 years of age
- Citizen of the United States
- Registered voter within the city or townships comprising the school district

### **ABSENTEE BALLOT:**

Absentee ballots are now available for eligible voters who cannot vote in person on December 18 due to:

- An illness or physical disability
- Travel related to school or business
- Vacation, college, military service outside Cattaraugus County

Call (716) 375-8018 to request an application for an absentee ballot by mail, or you may pick up an application at the OCSD Office, 410 W. Sullivan Street; Olean, NY 14760.

Absentee ballots will be mailed no later than December 11 in order for completed ballots to be returned to the OCSD Office by 5 p.m., December 18.





Propositions #1 & #2 Combined \$55,534,000

**VOTE:**  
Tuesday,  
December 18  
7 a.m.—9 p.m.  
Olean Middle  
School  
Music Suite



**State Building Aid  
& Other Sources 91.92%**



**Taxpayer  
Share 8.08%**

[www.oleanschools.org](http://www.oleanschools.org)

**BOARD OF EDUCATION**

Michael Martello, President  
Ira Katzenstein, Vice President  
John Bartimole  
Laurie A. Branch  
Gordon E. Cross  
Eric M. Garvin  
Steven H. Hamed  
Michiko H. McElfresh  
George Pancio

**ADMINISTRATION**

Mark J. Ward, Superintendent of Schools  
Ann O'Brien, Business Administrator

**OLEAN CITY SCHOOL DISTRICT  
410 W. Sullivan St.  
Olean, NY 14760**

Non-Profit Organ.  
US Postage  
**PAID**  
Permit No. 73  
Olean, NY 14760

Postal Patron Local

*Olean City School District - "Home, School, and Community: Educating for Life"*